

# MATMASKINERIET

year 3<sup>rd</sup> urbanism

architect Tin Phan

location Skøyen, Oslo, Norway

program residential, commercial, food court

duration 3 months

In a context where development in built mass and infrastructure in Fornebu has skyrocketed, it can potentially spur further development in between. Skøyen is right in the middle between Oslo S and Fornebu, making it a subject for further development, a gigantic hot spot.

The main target is to provide an ending to Karenslyst Allé. A multipurposed public space, which is a common ground where all the programs of the complex is connected (food court, office spaces, dwellings). The concept is simple, it is a modest thought of honesty and transparency in every program. This approach creates different spaces to when always exposed. There is a larger interest in showing the anatomy of the programs, its mechanics and machinery of how programs work in relation to eachother.

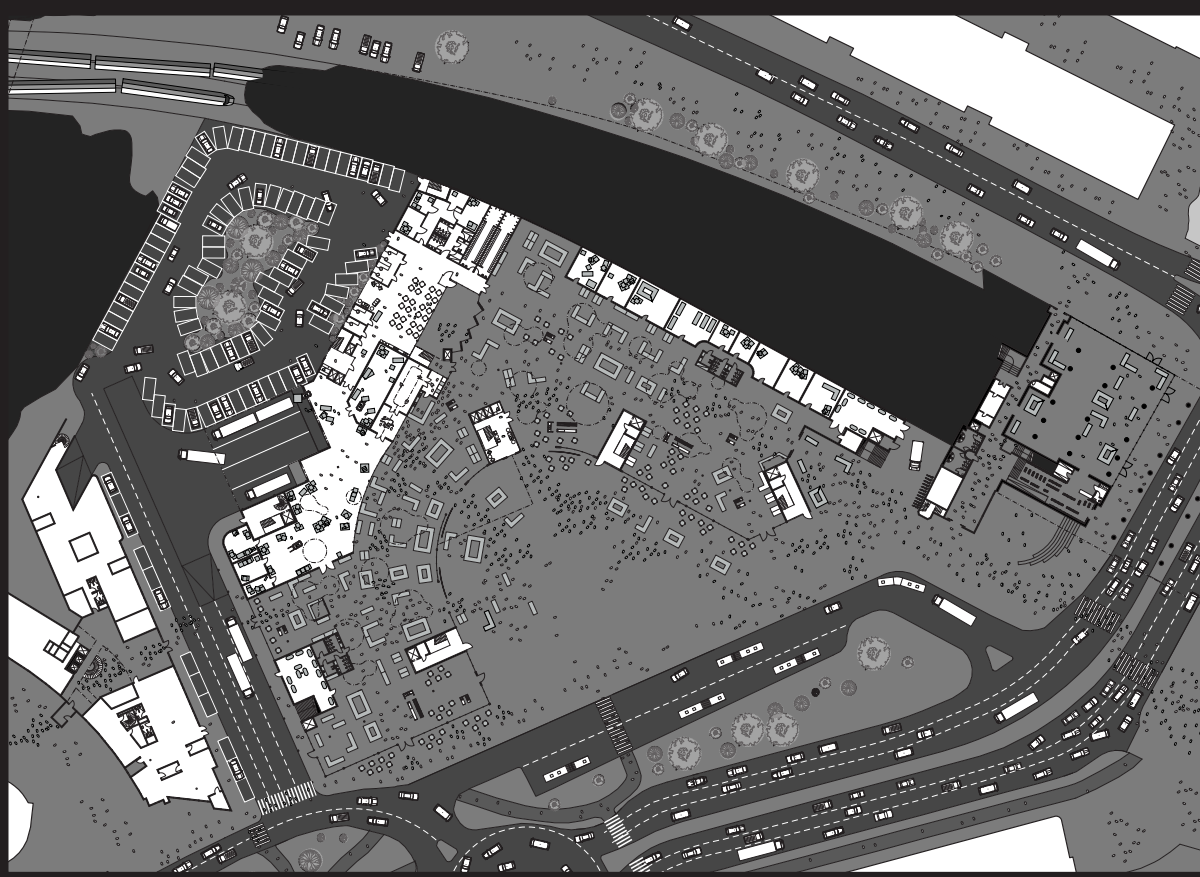
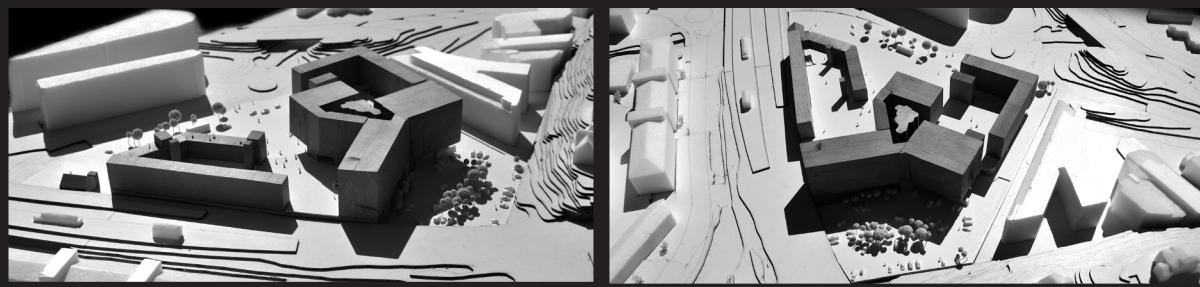
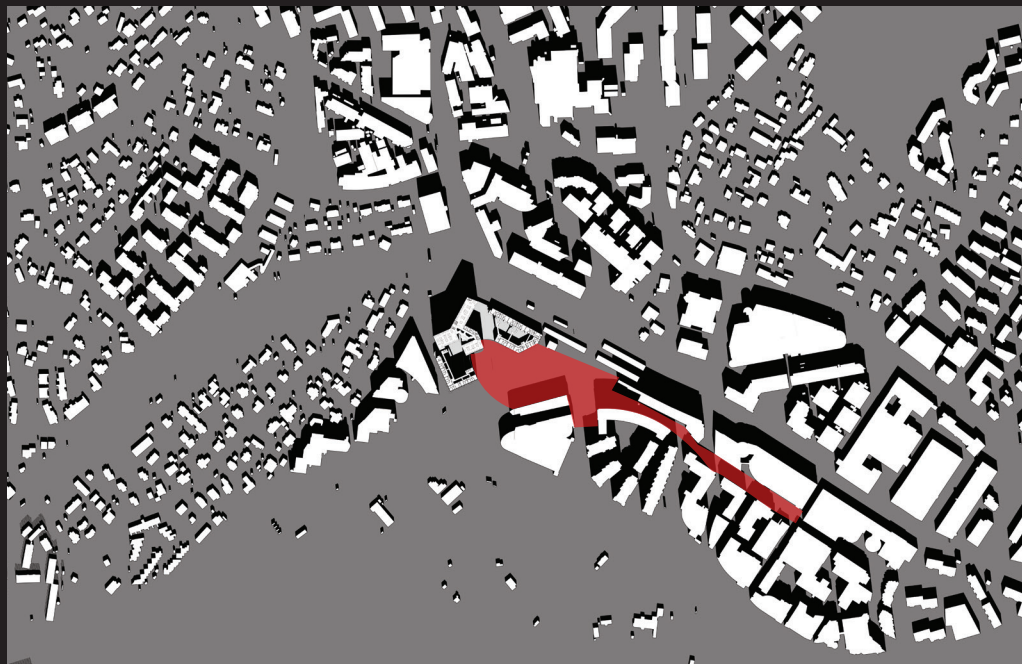

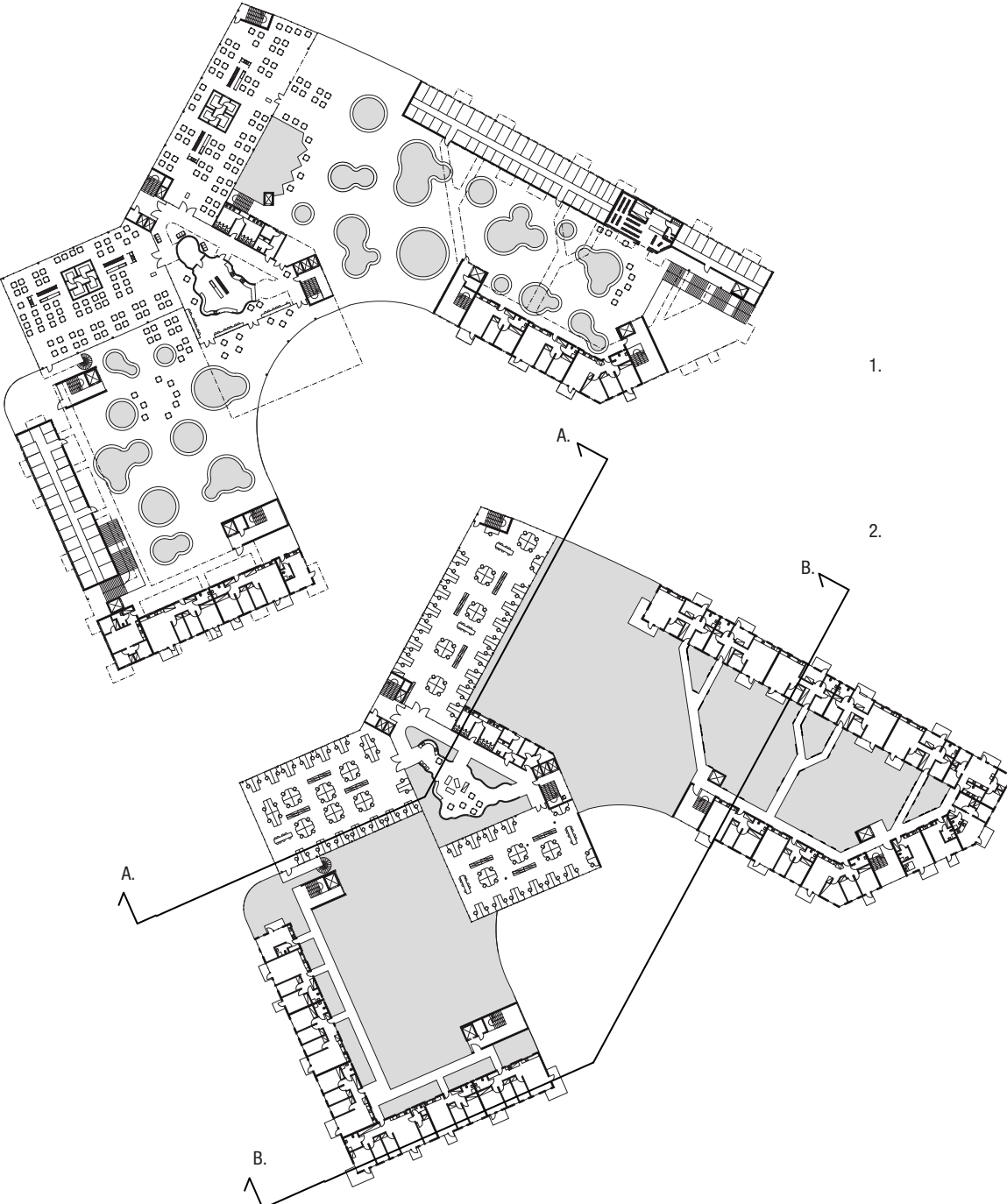

- 1. | 2nd plan, roof
- 2. | typical plan
- 3. | 6th plan, eastern block
- 4. | 4 bedrooms, 139 m2, 5 units
- 5. | 4 bedrooms, 100 m2, 4 units
- 6. | 3 bedrooms, 90 m2, 1 unit
- 7. | 3 bedrooms, 119 m2, 4 units
- 8. | 3 bedrooms, 120-145 m2, 17 units
- 9. | 3 bedrooms, 130-141 m2, 20 units
- 10. | 2 bedrooms, 95-102 m2, 18 units
- 11. | 2 bedrooms, 77 m2, 4 units
- 12. | 1 bedroom, 51-63 m2, units
- 13. | rooftop grillmodule (to the left)  
kitchen station 1 person (middle)  
kitchen station 7 persons (to the right)

